

**ΣΦΑΙΡΙΚΟΙ ΚΡΟΥΝΟΙ 150# & 300#**

TWO PIECES FLOATING BALL VALVES – CLASS 150~300#

**CHRYSSAFIDIS**

Size range: 2" to 10"

**STANDARDS:**

Design	API 6D & BS5351
Test	API 598
Face to Face Dimensions	ANSI B16.10
End Flange Dimensions	ANSI B16.5
Butt-Weld Ends	ANSI B16.25

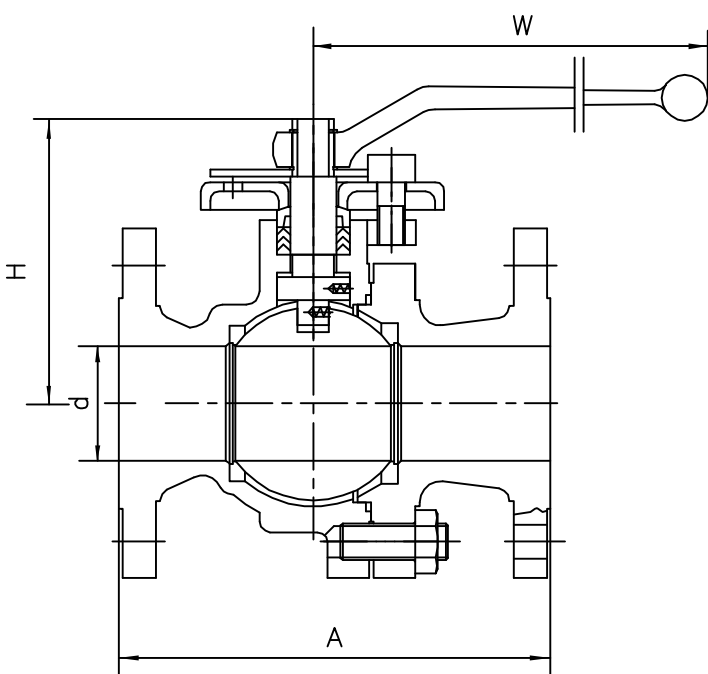
**Class 150# Fig No.32150F**
**DIMENSIONS AND WEIGHTS**

Size inch	d	A (RF)	H	W	Weight (Kg)
2"	51	178	110	230	10
3"	76	203	150	400	19
4"	102	229	180	700	33
6"	152	394	270	1100	93
8"	203	457	340	1200	150
10"	254	533	350	1300	200

**Class 300# Fig No.32300F**
**DIMENSIONS AND WEIGHTS**

Size inch	d	A (RF)	H	W	Weight (Kg)
2"	51	216	110	230	15
3"	76	283	150	400	35
4"	102	305	180	700	56
6"	152	403	270	1100	116
8"	203	502	340	1200	220
10"	254	568	350	1300	400

Other Sizes: On request

RF: Flanged      BW: Butt Weld

**AVAILABLE OPTIONS:**

STRUCTURE	End, Connection:	Flange Raised Face, Butt Weld, RTJ...
	Seat Rings:	Renewable
	Operation:	Lever, Gear, Electric, Pneumatic, Hydraulic...
MATERIALS	Body:	WCB, WC1, WC6, WC9, LCB, LCC, LC3, C5, C12, CF8, CF8M, CF3, CF3M, CF8C...
	Trims:	13%Cr, 304, 304L, 316, 316L, 321, 347, F-51, Monel...