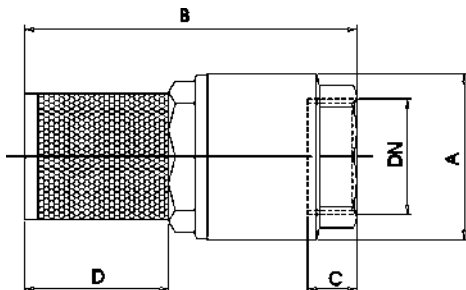

Brass universal check valve with stainless steel filter
ΠΟΤΗΡΙΑ ΑΝΑΡΡΟΦΗΣΗΣ ΜΕ ΑΝΟΞΕΙΔΩΤΗ ΣΙΤΑ
FEATURES

- BRASS "P-OT 58 Pb 2 UNI 5705-65" BODY.
- ACETAL COPOLYMER END CONNECTION
- STAINLESS STEEL AISI 302 SPRING.
- ACETAL COPOLYMER VALVE WITH NBR RUBBER GASKET.
- STAINLESS STEEL AISI 302 FILTER BASKET.
- SAND-BLASTED AND MACHINED FINISHING.
- THREADING TO ISO 228/1.

LEADING DIMENSIONS

DN	1/2"	3/4"	1"	1 1/4"	1 1/2"	2"	2 1/2"	3"	4"
A	34	42	47.5	58.5	68	81	103	112	144
B	72	82	94.5	105	119	138	161.5	166	190.5
C	10	13	14	14	15.5	15.5	21.5	22	30
D	29.5	33	41	47	54	64.5	76	78	90
FZ	70	70	80	120	180	200	230	265	310

FZ: minimum strength to fully open the valve (gr.)

WORKING PRESSURES AT 80° C MAX

PN 10	*	*	*	*	*	*	*	*	*	
	1/2"	3/4"	1"	1 1/4"	1 1/2"	2"	2 1/2"	3"	4"	p.s.i. 150

PRESSURE DROPS

R"	1/4	3/8	1/2	3/4	1	1 1/4	1 1/2	2	2 1/2	3	4
Kv	-	-	4,1	6.8	11	23	29.5	51.8	-	-	-

$$\Delta P \text{ [mm H}_2\text{O]} = 10.000 \times \left[\frac{G \text{ [m}^3\text{/h]}}{Kv} \right]^2$$